

# THE EAST GRINSTEAD SOCIETY 2011

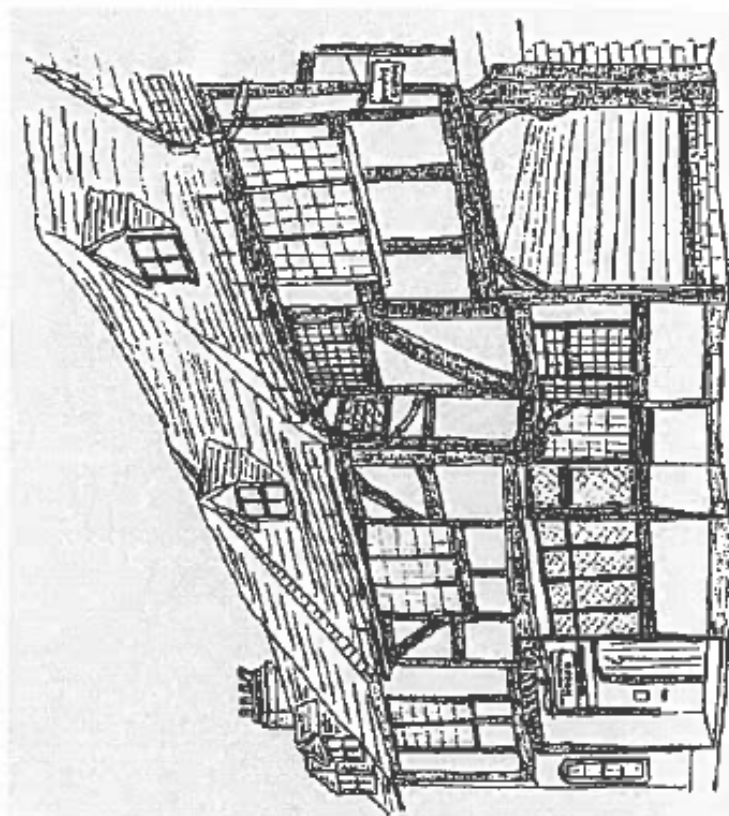

## Wilmington House, 48-50 High Street

The centre timber-framed section dates from the 16th century and the western part is an early 14th century Hall House.  
A fine carved, moulded dais beam, dated at about 1340, visible in the passage-way, was part of the original Hall House.

**PRESIDENT** – Mr M J Leppard

**CHAIRMAN**

Mr J W Bridle  
7 Dexter Drive  
East Grinstead  
RH19 4SU  
Tel: 01342 313485

**VICE-CHAIRMAN**

Dr C J V Wheatley  
4 Portland Road  
East Grinstead  
RH19 4DZ  
Tel: 01342 321525

**HON. TREASURER**

Mr N J Beale  
10 Austen Close,  
East Grinstead  
RH19 1RZ  
Tel: 01342 326767

**HON. SECRETARY** Vacant

**MEMBERSHIP  
& PROGRAMME**

Mr C V Bowley  
2 Eastern Road  
Lindfield  
RH16 2LP  
Tel: 01444 482576

**COMMITTEE  
MEMBERS**

Mr C V Bowley  
Mrs J Roberts  
Mrs L A Sansom  
Mrs B Stovold  
Mr R Maynard  
Mr M R Lyons (Co-opted)

The East Grinstead Society monitors planning applications and cares for buildings & amenities in the town and surroundings.

# PROGRAMME 2011

- Friday  
February 18th **OPEN FORUM**  
An opportunity to discuss current issues facing East Grinstead and the Society
- Friday  
March 18th **THE STORY OF SHOREHAM AIRPORT**  
A talk by TIM HOGBEN
- Wednesday  
April 6th **SPRING GARDEN TOUR, WITH TEA AT A COST, GRAVETYE MANOR**  
Led by the Head Gardener. Maximum 16 places; reservations please on 01342 321525
- Friday  
April 15th **SCATTERED SQUALOR - DOWNLAND HOMES**  
Un-regulated housing along coastal South Downs between the wars by GEOFFREY MEAD
- Saturday 10am -  
April 23rd 1pm **TOWN & COUNTRY HERITAGE: WEST HOATHLY TO EAST GRINSTEAD**  
Walk from St Margaret's Parish Church, West Hoathly led by CHRISTOPHER WHEATLEY  
(For help with transport, please call 01342 321525)
- Sunday 2.30pm  
May 1st **19th and 20th CENTURY EAST GRINSTEAD: TOWN TRAIL 2**  
A guided walk starting from High Street War Memorial, led by ANGELA COLE  
(For further information, please call 01342 321525)
- Monday 10am -  
May 2nd 4pm **MAY FAIR: SOCIETY STALL IN HIGH STREET**  
A chance to buy second-hand books, home-made jams, cakes and the Society's publications
- Friday  
May 20th **THE BALCOMBE TUNNEL MURDER**  
by JAMES GARDENER
- Saturday 9.30am -  
May 28th 4pm **STAINED GLASS & CONVENT ARCHITECTURE**  
Ashdown Park Hotel, Speldhurst and Tudeley, with pub lunch. Reservations please on 01342 321525
- Sunday  
June 12th 2.30pm **EAST GRINSTEAD'S VICTORIAN HERITAGE; TOWN TRAIL 3**  
Walk starting from Chequer Mead Arts Centre, led by CHRISTOPHER WHEATLEY  
(For further information, please call 01342 321525)
- Friday  
June 17th **THE THIRD EARL OF SHEFFIELD AND HIS PASSION FOR CRICKET**  
by BRIAN TESTER
- Friday  
July 15th **THOMAS TURNER, DIARIST**  
A talk about the East Hoathly man and his diaries. By JOHN FORD
- Thur. to Sun.  
Sept. 8th to 11th **HERITAGE OPEN DAYS: FREE ACCESS TO LOCAL BUILDINGS AND EVENTS.**  
**GUIDED WALK THROUGH HISTORIC EAST GRINSTEAD;** starting from St Swithun's Church at 2.30pm on Sunday Sept.11th, led by ELKE WAGSTAFF  
(For further information, see website/local library, or, please call 01342 321525)
- Friday  
Sept. 16th **TEA AND THE ENGLISH**  
by Dr SALLY WHITE
- Saturday  
Sept. 17th 9am **LONDON OPEN HOUSE: SMALL GROUP OUTING BY TRAIN**  
Meet at East Grinstead Railway Station for a day excursion to see some notable buildings  
(For further information, please call 01342 321525)
- Friday  
October 21st **44th ANNUAL GENERAL MEETING**  
Followed by a talk
- Friday  
November 18th **A RAMBLE THROUGH THE VICTORIAN WEALD**  
A talk illustrated by original Victorian magic lantern and slides, by PETER GILLIES
- Friday  
December 9th **THE FUTURE OF HAYWARDS HEATH, THE TOWN WITHOUT A PAST**  
by COLIN MANTON

Friday meetings start at 7.30pm in Main Hall, East Court, with a charge of £1.00/member for coffee.

Non-members welcome at £1.50/person for Friday meetings and £2/person for other events, children free.

For evening meetings information contact Programme Secretary, Tel: 01444 482576, Email: bowley902@btinternet.com

Website: [www.eastgrinsteadsociety.org](http://www.eastgrinsteadsociety.org)

(Illustration: Wilmington House, sketch by CJV Wheatley © 2010)